

OVERALL DRAWING 0-36913
PRESS SPEED 20-40 SPM
PRESS SPECIFICATIONS :

- 440 US TONS PRESS CAPACITY
- 1/4 INCH RATED POSITION
- 110 IN-TONS RATED ENERGY @ 20 SPM
- 12 INCHES STROKE
- 20 - 40 SPM SPEED
- 36.0 INCHES SHAFTER THICKNESS (OVER BED)
- 7.50 INCHES ADJUSTMENT OF SLIDE
- 12.0 INCHES TOTAL WEIGHT (APPROX)
- 103,000 LBS. AIR CONSUMPTION PER STROKE
- 1.65 FT PER MIN. @ 90 PSI
- 440 VOLTS VOLTAGE
- 3 PHASE PHASE
- 60 HZ FREQUENCY
- 60 HP/1750 RPM MAIN MOTOR
- 88.8 AMPS AVERAGE RECD

1.00 X .50 KEYS UP POSITION UP - STROKE UP

5.50 DIA.

10.75 SHAFT EXTENSION

- 40.00 DIE BLOCK
- 60.00 AIR MANIFOLD AND LUBRICATION SYSTEM COMPARTMENT (FRONT OF PRESS)
- 15 FOOT LONG FLEXIBLE CONDUIT FROM RIGHT FRONT CORNER OF PRESS
- CONTROL ENCLISURE CONSOLE TYPE

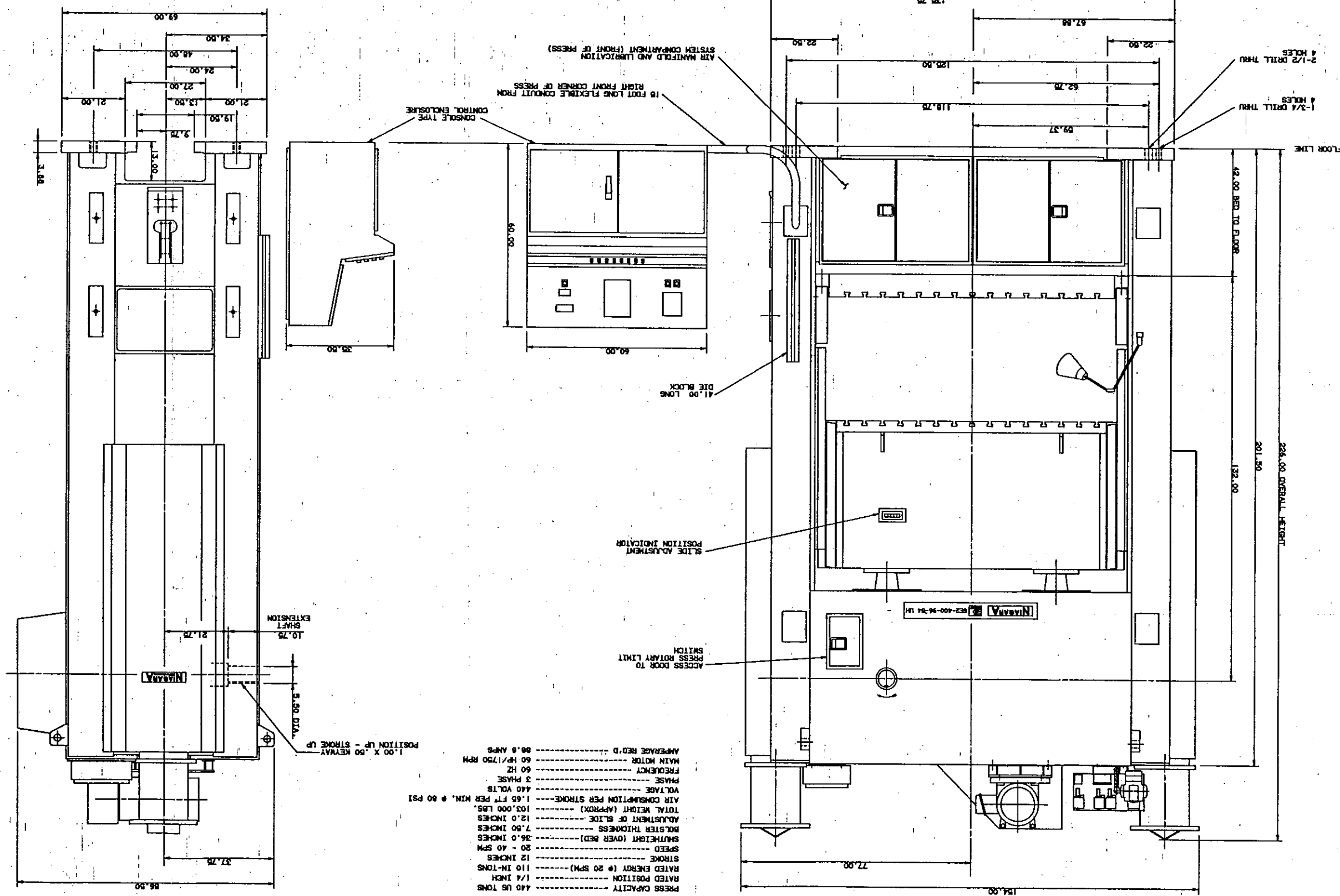

TRANSMITTAL FROM		REVISION	
NO.	DATE	NO.	DATE
ATTENTION: NO REVISIONS TO THIS DRAWING MUST BE MADE ON THE DRAWING SET.			
UNLESS OTHERWISE SPECIFIED		TITLE OVERALL DRAWING	
MODEL NO. SE2-400-96-54 LH PRESS		NIGARA	
DRAWING NO. 0-36913		DATE 1-3-54	
BY: [Signature]		CHECKED: [Signature]	
APPROVED: [Signature]		DATE 1-3-54	
REVISIONS TO BE MADE TO THIS DRAWING		REVISIONS TO BE MADE TO THIS DRAWING	
NO.	DATE	NO.	DATE

PLT DATE: 1-3-54